

HUNTERS®

HERE TO GET *you* THERE



Bertrand Way

Thamesmead, SE28 8LN

Guide Price £325,000



Guide Price £325,000-£350,000 As vendors sole agents Hunters are delighted to bring to market this two bedroom end terrace home situated in a cul de sac in North Thamesmead. The property comprises a lounge, kitchen/diner, two double bedrooms and a first floor bathroom and is situated on a large plot with front and rear gardens.

The property is within easy reach of Bishop John Robinson Primary School with bus links to Abbey Wood and Woolwich just a short distance. Thamesmead Town Centre and it's array of shops is just 0.6miles from the property.

The property has the additional benefit of allocated parking.



ENTRANCE

LOUNGE 13'2" x 12'4" (4.01 x 3.76)

KITCHEN DINER 12'3" x 9'3" (3.73 x 2.82)

BEDROOM ONE 12'4" x 8'10" (3.76 x 2.69)

BEDROOM TWO 12'3" x 7'3" (3.73 x 2.21)

BATHROOM 9'0" x 4'9" (2.74 x 1.45)

FRONT GARDEN

REAR GARDEN

Area Map



Floor Plans

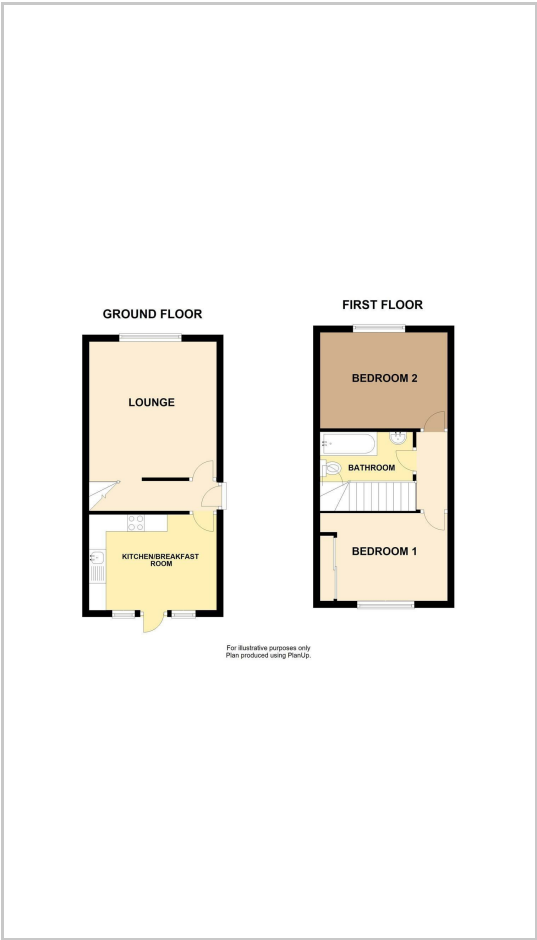

Energy Efficiency Graph

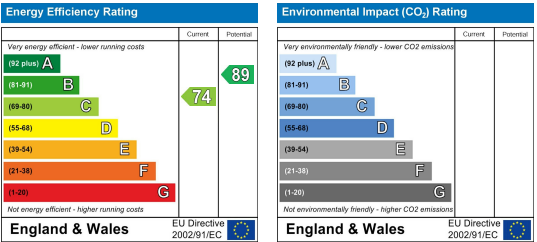

These particulars are intended to give a fair and reliable description of the property but no responsibility for any inaccuracy or error can be accepted and do not constitute an offer or contract. We have not tested any services or appliances (including central heating if fitted) referred to in these particulars and the purchasers are advised to satisfy themselves as to the working order and condition. If a property is unoccupied at any time there may be reconnection charges for any switched off/disconnected or drained services or appliances - All measurements are approximate. **THINKING OF SELLING?** If you are thinking of selling your home or just curious to discover the value of your property, Hunters would be pleased to provide free, no obligation sales and marketing advice. Even if your home is outside the area covered by our local offices we can arrange a Market Appraisal through our national network of Hunters estate agents.